

LARGE FORMAT 3D PRINTERS

BERLIN-1

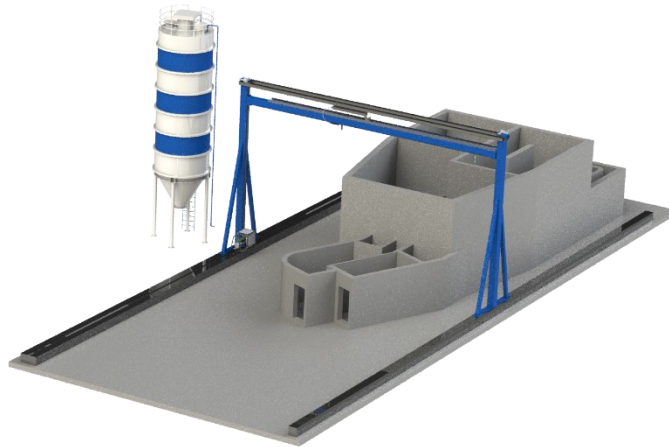

OVERVIEW

The Berlin-1 is an industrial, 3-axis, turnkey Cartesian flying gantry printer system that can facilitate 24/7 continuous production and large single element creation. This printer is available in different configurations; from a minimum of 10m*10m*4m build volume to a maximum of 40m*15m*9m build volume.

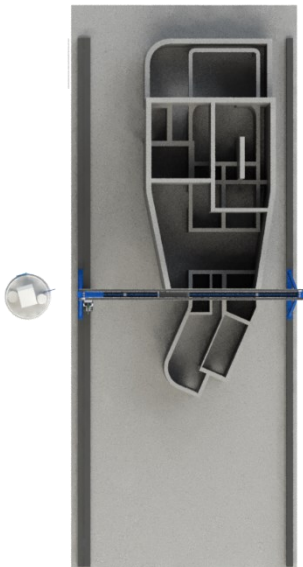

SPECIFICATIONS

MECHANICAL	
Maximum Print Speed (mm/s)	~300
Available Nozzle Sizes (Dia. - mm)	12-40
Nominal Bead Ratio W:H	3:1
Approx. Min-Max Bead Width (mm)	20-68
Approx. Min-Max Layer Height (mm)	0-30
Water Pressure Min-Max (PSIG)	30-60
ELECTRICAL	
Voltage	3~ 400/480V
Input Frequency (Hz)	50-60
CONTROLS	
Motion Controller	Centroid or equivalent
Language	G-Code Control
SAFETY	
Integrated E-Stop loops	Included
Light curtains and additional interlocks	Upon Request
SOFTWARE	
Basic Slicing Components	Included
Advanced Slicing Components	Upon Request
SERVICES	
Commissioning	10 Days included
Setup-time (normal use)	1 Day
On-site Operator Training	Included

TAMs PROMISE

Twente Additive Manufacturing supplies the new systems with a 24-month warranty and 1 year of remote support included. The client focused approach to service ensures client success.

VALUE-ADDED FEATURES

“Start-Stop” Pumping Control, Variable flow-rate output, 2-Stage Mixing Chambers, Semi-continuous mixing, HMI with data acquisition and logging, Easy clean-up, Flow regulated water pump, Optional dust extractor, Optional material conveyor for automated material feeding.